

GF-1[®]

**COMPLETE MOUNT
& FLASHING ASSEMBLY**

INSTALLATION GUIDE

REVISION: 08/02/22

VERSION: V2.5

GF-1

INSTALLATION GUIDE



EcoFasten[®]
For Installers. By Installers.

CLICKING THE PAGE NAME WILL TAKE YOU TO THAT PAGE

<u>TABLE OF CONTENTS</u>	<u>PAGE 01</u>
<u>FEATURES & BENEFITS</u>	<u>PAGE 02</u>
<u>COMPONENTS</u>	<u>PAGE 03</u>
<u>INSTALLATION</u>	<u>PAGE 04</u>
<u>LINE DRAWINGS</u>	<u>PAGE 06</u>
<u>SPECIFICATIONS</u>	<u>PAGE 18</u>

GF-1

INSTALLATION GUIDE

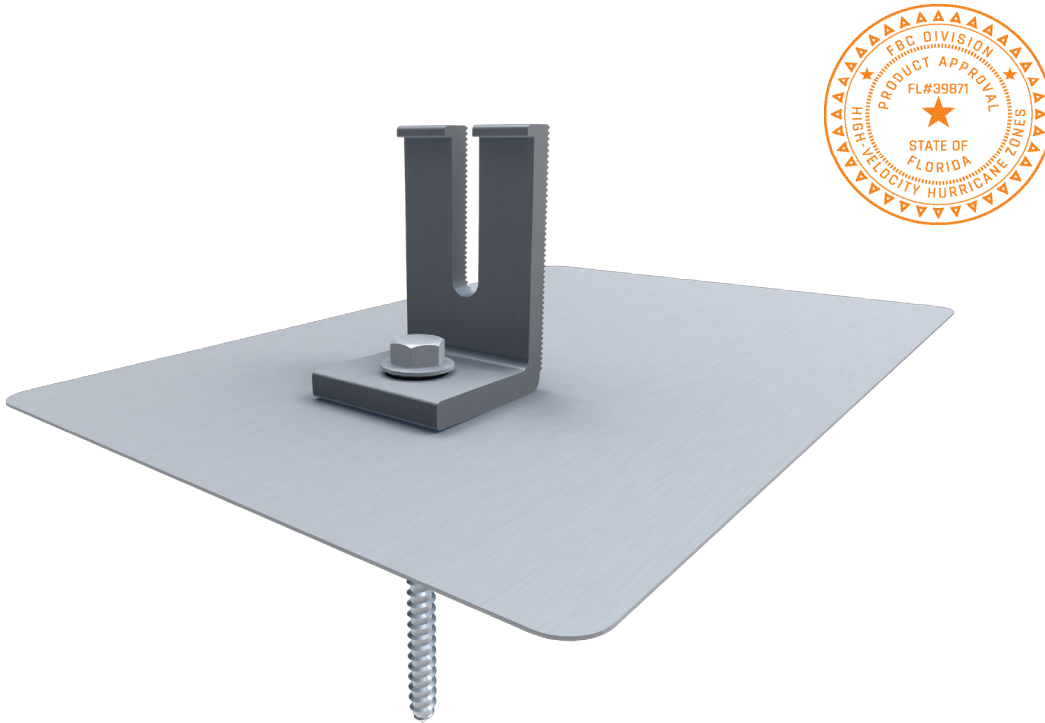

GF-1

GF-1 is our most versatile solution for composition shingle roofs. Install the flashing using a single fastener for a quick & easy installation. When using the GF-1 flashing grommet and an EcoFasten compression bracket, a watertight seal is created, maintaining the integrity of the roof.

FEATURES

- Mill or black finish
- Patented Watertight Technology
- Installs without removing shingles
- Single lag bolt attachment
- Compatible with a variety of compression brackets
- Florida Product Approved for any combination of 8"x12" GF-1 flashing with the ClickFit L-foot & Lag Screw

FEATURES + BENEFITS

GF-1

INSTALLATION GUIDE



EcoFasten[®]
For Installers. By Installers.

SYSTEM COMPONENTS

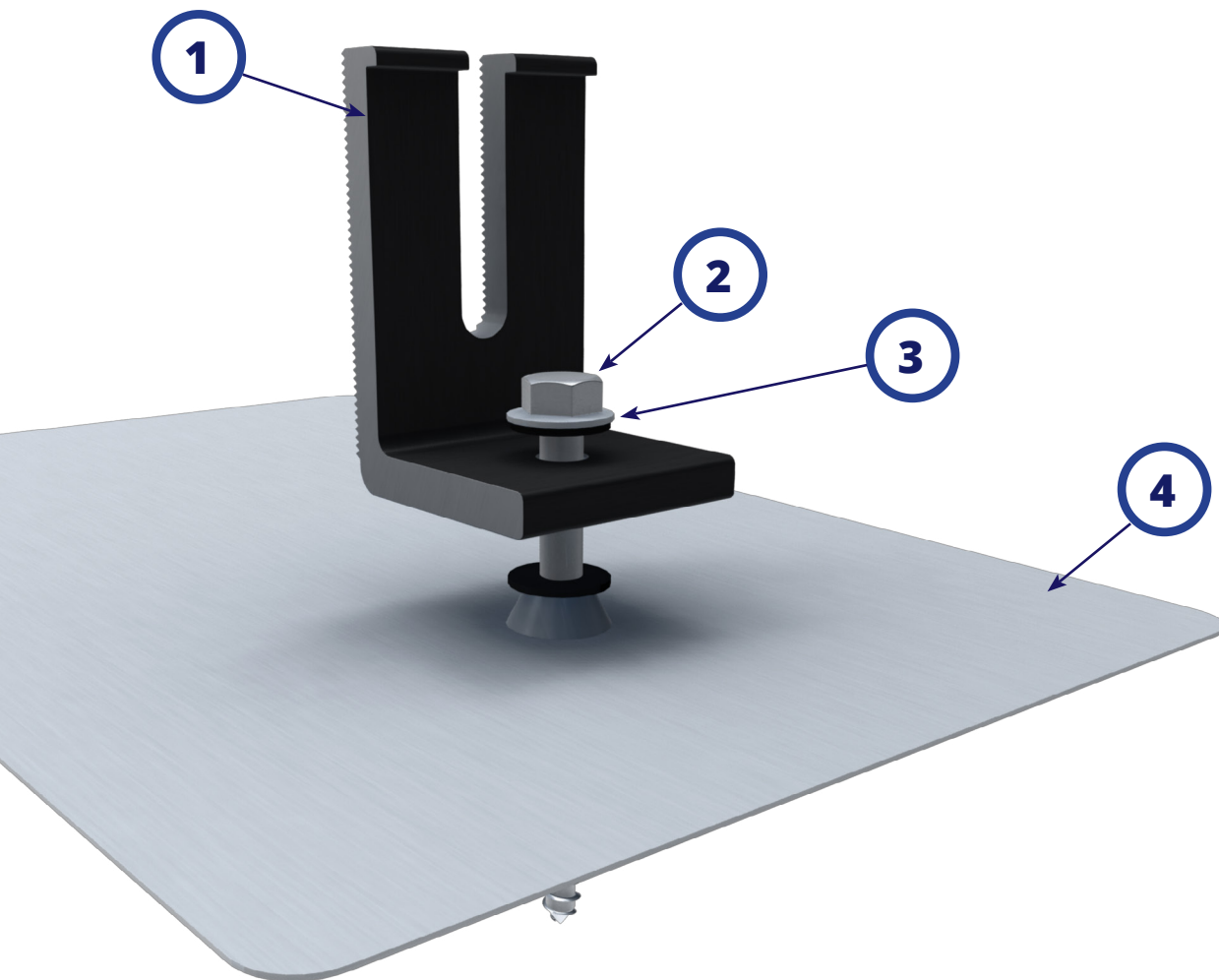

1. L-FOOT SCL-101 BLK 3"
(OTHER OPTIONS AVAILABLE)

2. 5/16" LAG BOLT
(AVAILABLE IN 3" AND 4")

3. 5/16" EPDM BONDED WASHER

4. GF-1 FLASHING GLV MLL 8X12" -
GALVALUME FLASHING WITH PRE-
INSTALLED EPDM RUBBER GASKET

(AVAILABLE IN 8X10 & 8X12, WITH MILL & BLACK
FINISH OPTIONS)

COMPONENTS

GF-1

INSTALLATION GUIDE



INSTALLING GF-1

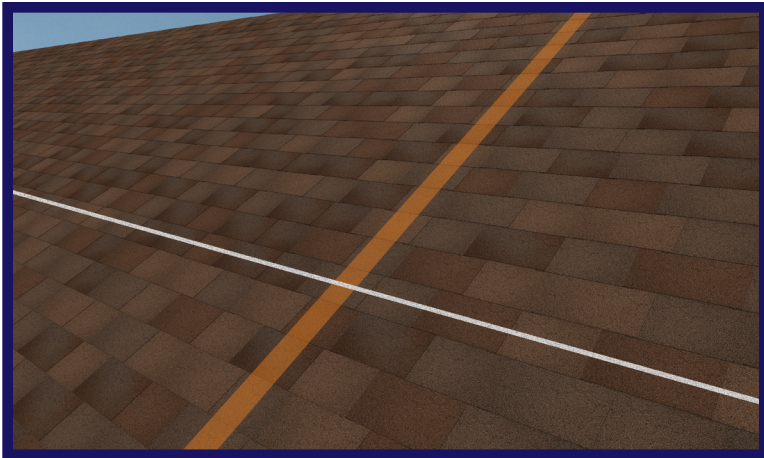

Snap horizontal lines across the roof to mark the mount rows, then locate the rafter and mark the installation position of each GF-1 flashing.

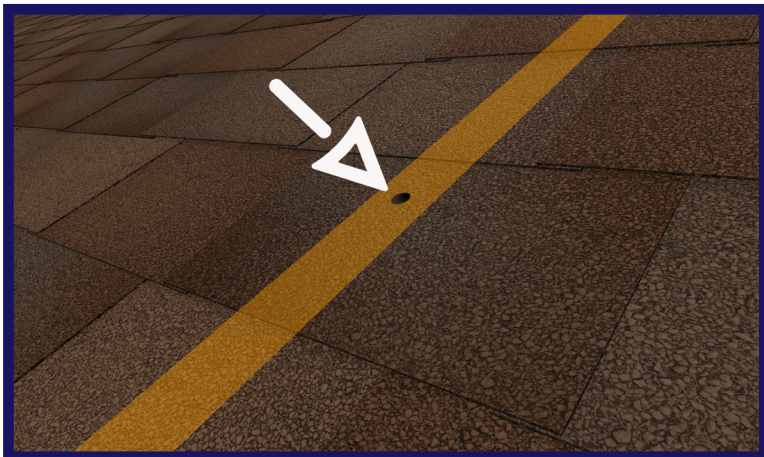

Drill a 7/32" pilot hole into the rafter or structural member for the lag screw. Backfill with sealant compatible with the roof type.

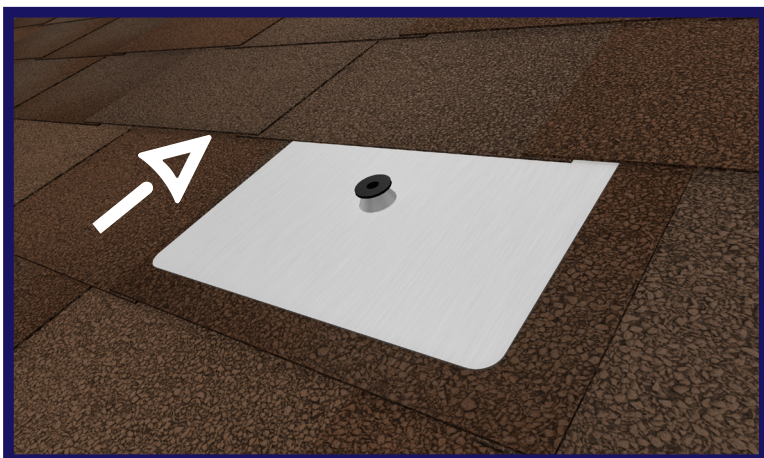

Slide flashing up under the next row of shingles directly above the pilot hole, taking care to align the hole in the flashing with the pilot hole.

GF-1

INSTALLATION GUIDE



EcoFasten[®]
For Installers. By Installers.

INSTALLING GF-1

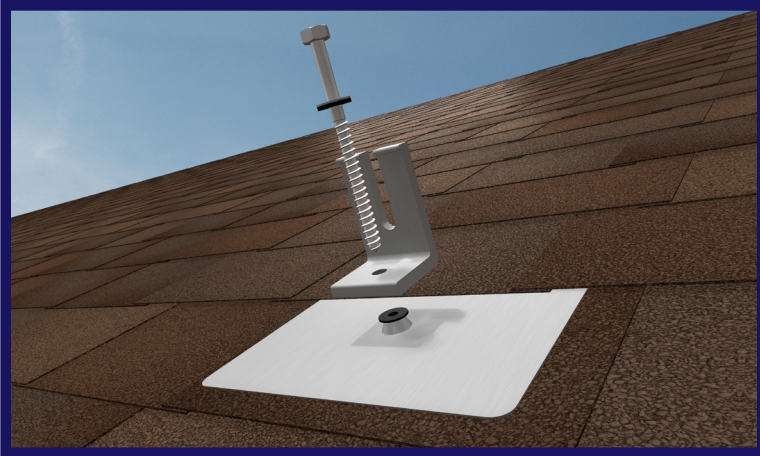

Thread the EPDM bonded washer onto the lag bolt followed by one of EcoFasten's compression brackets and then insert the lag bolt into the gasketed hole in the flashing.

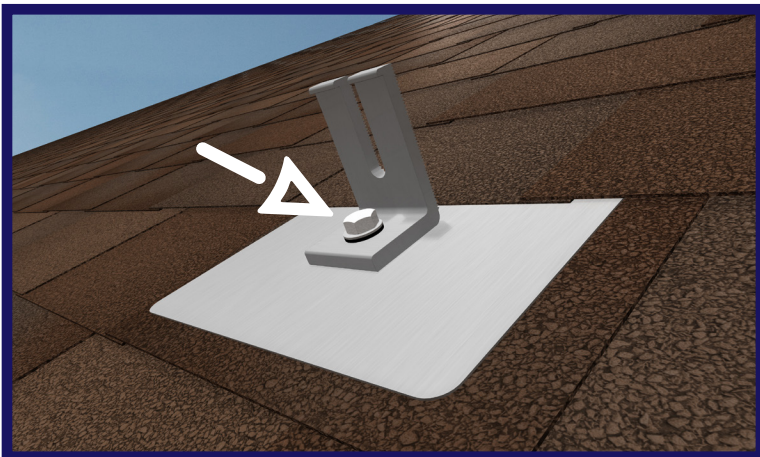

Drive the lag bolt down into the rafter using an impact driver. Torque range is between 100-400 torque inch-pounds depending on the type of wood and time of year. The visual indicator for proper torque is when the EPDM on the underside of the bonded washer begins to push out the sides as the washer compresses. Do not over torque.

INSTALLATION

GF-1

INSTALLATION GUIDE



CUT SHEET: GF-1 FLASHING GLV BLK 8X12"

PART NUMBER	DESCRIPTION
3012010	GF-1 FLASHING GLV BLK 8X12"

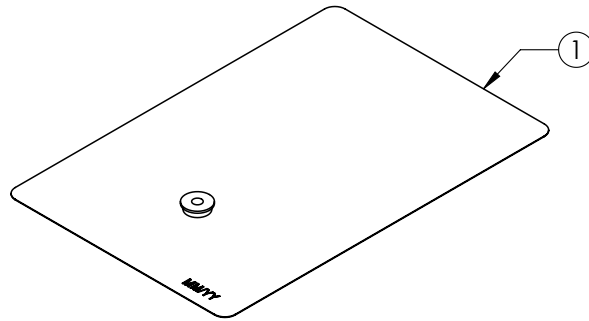

ITEM NO.	DESCRIPTION
1	GF1-GAL-BLK-812

1) GF1-GAL-BLK-812

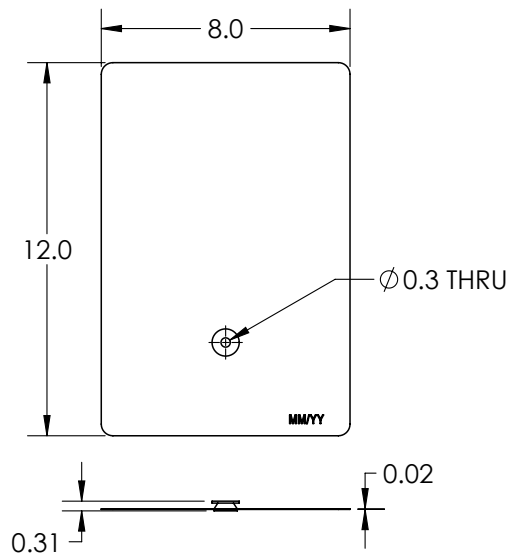

Material	Corrosion Resistant Steel
Finish	Black

REV.- CS1

LINE DRAWINGS

GF-1

INSTALLATION GUIDE



CUT SHEET: GF-1 FLASHING GLV MLL 8X12"

PART NUMBER	DESCRIPTION
3012011	GF-1 FLASHING GLV MLL 8X12"

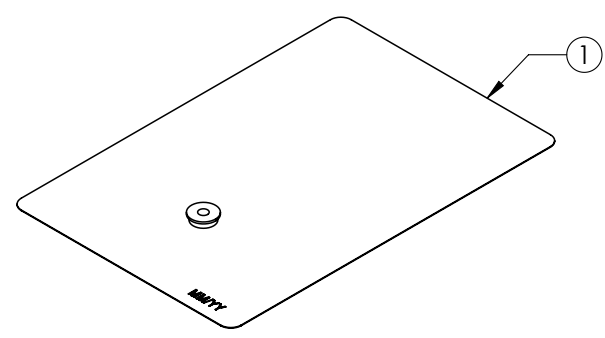

ITEM NO.	DESCRIPTION
1	GF1-GAL-MLL-812

1) GF1-GAL-MLL-812

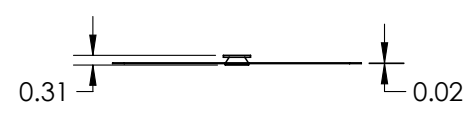
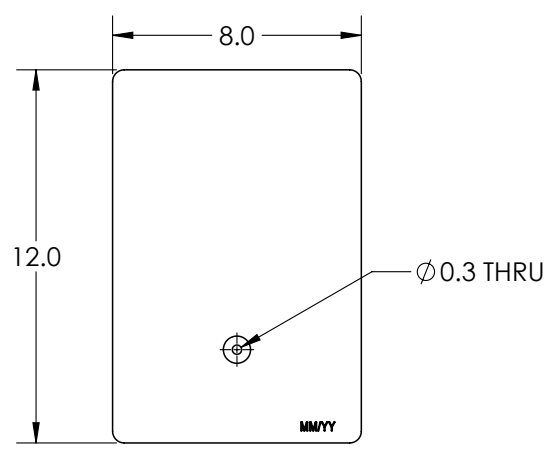

Material	Corrosion Resistant Steel
Finish	Mill

REV.- CS1

LINE DRAWINGS

GF-1

INSTALLATION GUIDE



CUT SHEET: GF-1 FLASHING GLV BLK 8X10"

PART NUMBER	DESCRIPTION
3012020	GF-1 FLASHING GLV BLK 8X10"

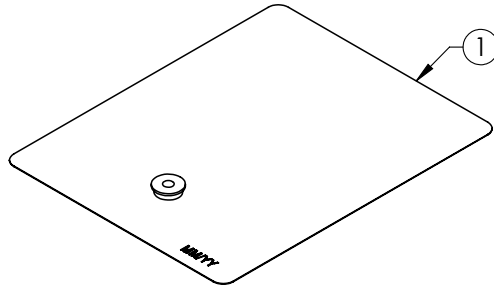

ITEM NO.	DESCRIPTION
1	GF1M-GAL-BLK-810 W/O WASHER ASSEMBLY

1) GF1M-GAL-BLK-810 W/O WASHER ASSEMBLY

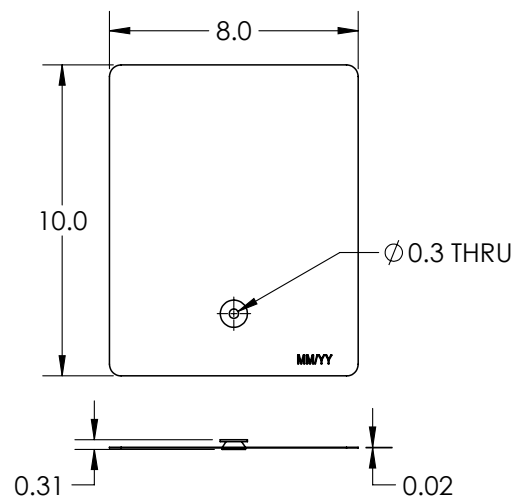

Material	Corrosion Resistant Steel
Finish	Black

REV.- CS1

GF-1

INSTALLATION GUIDE



CUT SHEET: GF-1 FLASHING AL BLK 8X12"

PART NUMBER	DESCRIPTION
3012013	GF-2V FLASHING AL BLK 8X12"

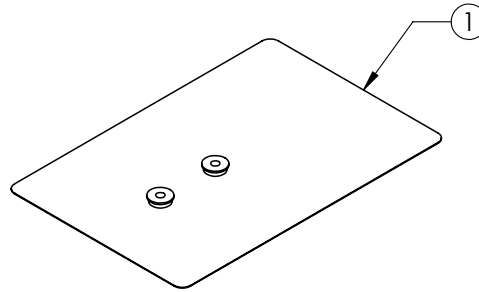

ITEM NO.	DESCRIPTION
1	GF2V 8X12 MATTE BLK FLASHING

1) GF2V 8X12 MATTE BLK FLASHING

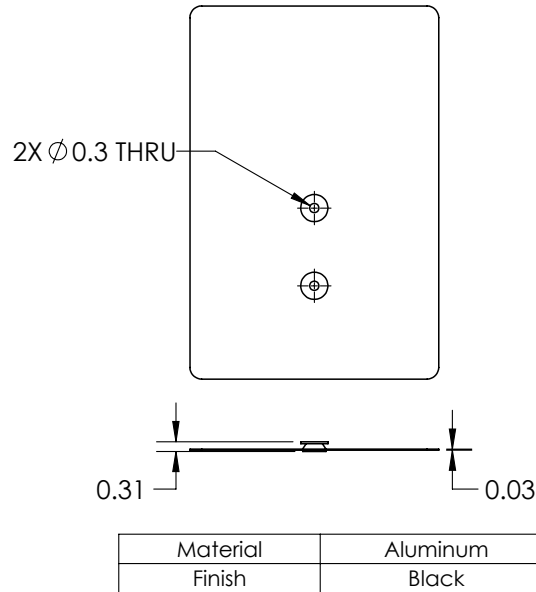

REV.- CS1

GF-1

INSTALLATION GUIDE



CUT SHEET: L-FOOT L-102 BLK 3"

PART NUMBER	DESCRIPTION
3011015	L-FOOT L-102 BLK 3"

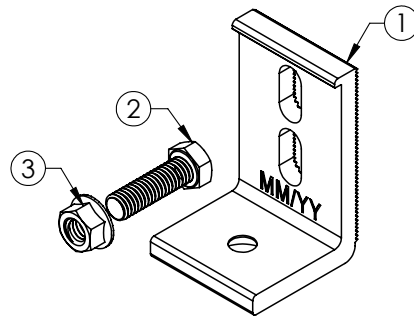

ITEM NO.	DESCRIPTION
1	L-102-3 ANOD BLK
2	SS HEX HD CAP SCREW, FULL THD, 3/8-16 UNC X 1.25 LONG
3	SS SERRATED FLANGE LOCK NUT, 3/8-16

1) L-102-3 ANOD BLK

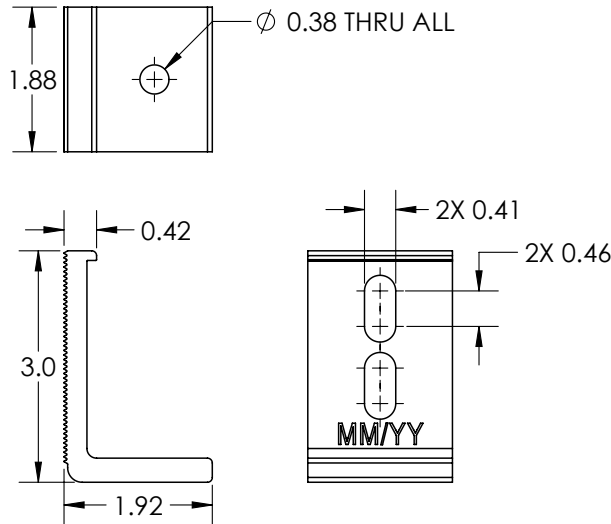

Material	Aluminum
Finish	Black

REV.- CS1

LINE DRAWINGS

GF-1

INSTALLATION GUIDE



CUT SHEET: L-FOOT L-102 MLL 6"

PART NUMBER	DESCRIPTION
3011016	L-FOOT L-102 MLL 6"

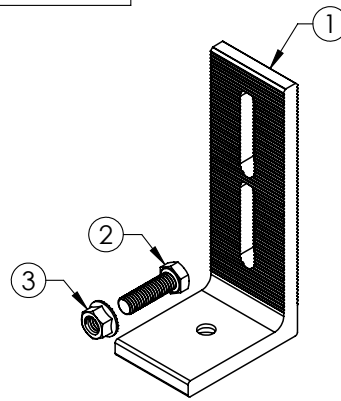

ITEM NO.	DESCRIPTION
1	L-102-6
2	SS HEX HD CAP SCREW, FULL THD, 3/8-16 UNC X 1.25 LONG
3	SS SERRATED FLANGE LOCK NUT, 3/8-16

1) L-102-6

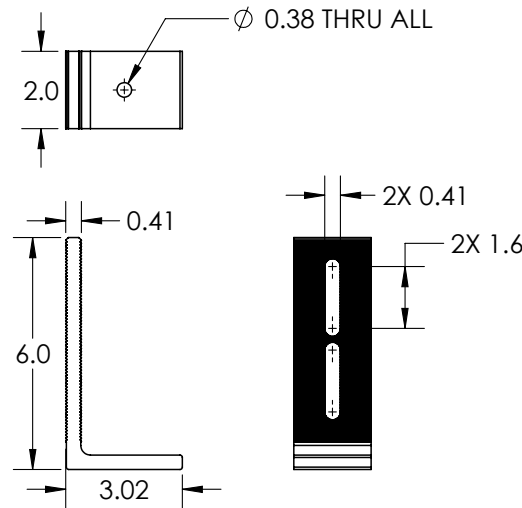

Material	Aluminum
Finish	Mill

REV.- CS1

LINE DRAWINGS

GF-1

INSTALLATION GUIDE



CUT SHEET: L-FOOT SCL-101 MLL 3"

PART NUMBER	DESCRIPTION
3011017	L-FOOT SCL-101 MLL 3"

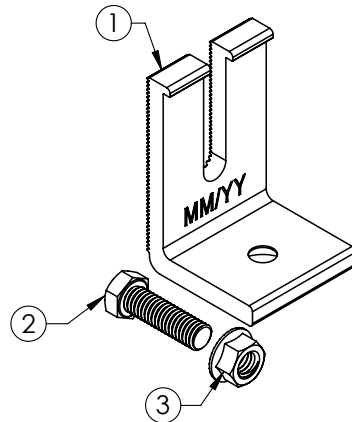

ITEM NO.	DESCRIPTION
1	L FOOT W/ STANDARD DIMPLE AND OPEN SLOT, 3 IN TALL MLL
2	SS HEX HD CAP SCREW, FULL THD, 3/8-16 UNC X 1.25 LONG
3	SS SERRATED FLANGE LOCK NUT, 3/8-16

1) L FOOT W/ STANDARD DIMPLE AND OPEN SLOT, 3 IN TALL MLL

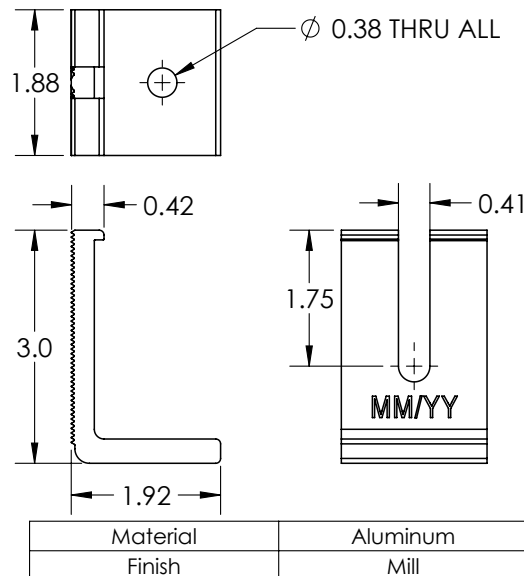

REV.- CS1

LINE DRAWINGS

GF-1

INSTALLATION GUIDE



CUT SHEET: L-FOOT SCL-101 BLK 3"

PART NUMBER	DESCRIPTION
3011018	L-FOOT SCL-101 BLK 3"

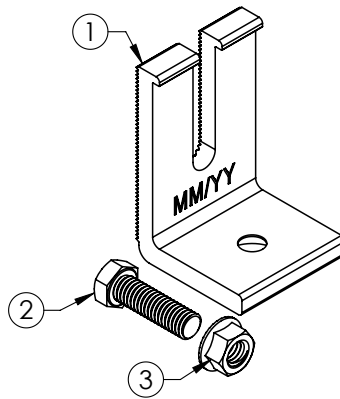

ITEM NO.	DESCRIPTION
1	L FOOT W/ STANDARD DIMPLE AND OPEN SLOT, 3 IN TALL BLK
2	SS HEX HD CAP SCREW, FULL THD, 3/8-16 UNC X 1.25 LONG
3	SS SERRATED FLANGE LOCK NUT, 3/8-16

1) L FOOT W/ STANDARD DIMPLE AND OPEN SLOT, 3 IN TALL BLK

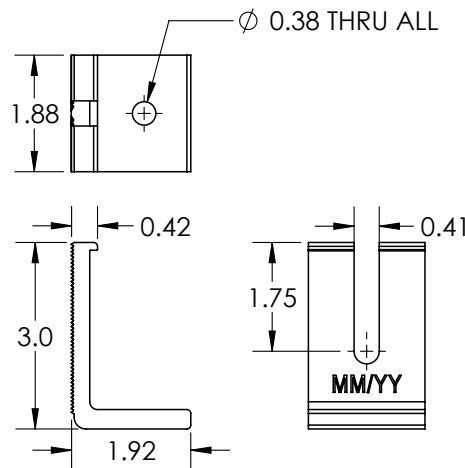

Material	Aluminum
Finish	Mill

REV.- CS1

LINE DRAWINGS

GF-1

INSTALLATION GUIDE



CUT SHEET: CF UNIV L-FOOT MLL 3"

PART NUMBER	DESCRIPTION
2012022	CF UNIV L-FOOT MLL 3"

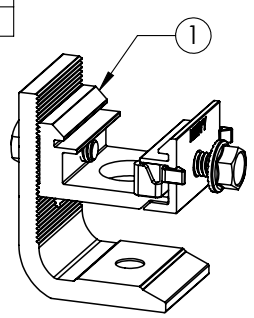

ITEM NO.	DESCRIPTION
1	CLICKFIT L FOOT ASSEMBLY

1) CLICKFIT L FOOT ASSEMBLY

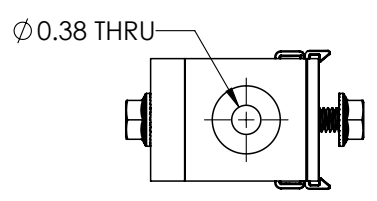
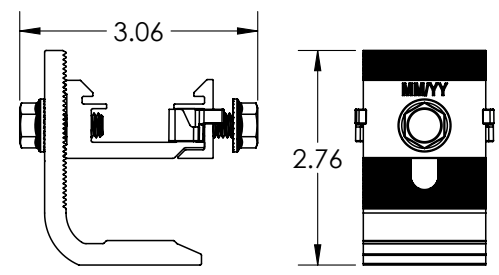
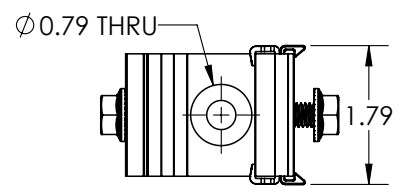

Material	Aluminum/Stainless Steel
Finish	Mill

REV.- CS1

LINE DRAWINGS

GF-1

INSTALLATION GUIDE



CUT SHEET: LAG SCREW SS .313X4

PART NUMBER	DESCRIPTION
3016017	LAG SCREW SS .313X4" W/BW (50)

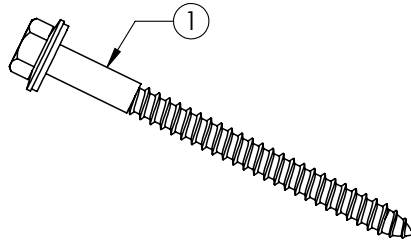

ITEM NO.	DESCRIPTION
1	LAG SCREW, 5/16-4", THREAD 3", EPDM BACKED WASHER

1) LAG SCREW, 5/16-4", THREAD 3", EPDM BACKED WASHER

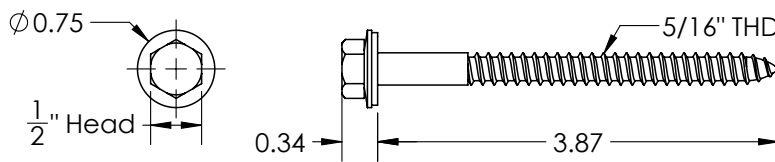

Material	Stainless Steel/EPDM
Finish	Mill

REV.- CS1

LINE DRAWINGS

CUT SHEET: EPDM BOND WASHER SS .313" (51)

PART NUMBER	DESCRIPTION
3016014	EPDM BOND WASHER SS .313" (51)

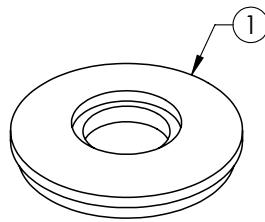

ITEM NO.	DESCRIPTION
1	5/16 STAINLESS STEEL AND EPDM BONDED SEALING WASHER

1) 5/16 STAINLESS STEEL AND EPDM BONDED SEALING WASHER

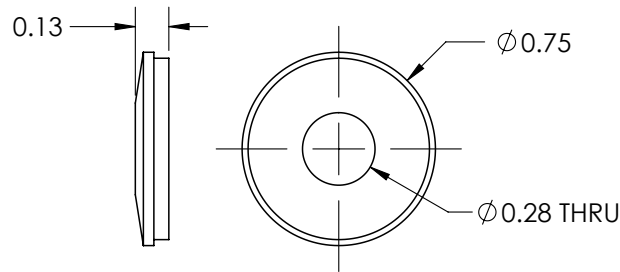

Material	Stainless Steel/EPDM
Finish	Mill

REV.- CS1

GF-1

INSTALLATION GUIDE



CUT SHEET: RI COMP SLIDE AL BLK

PART NUMBER	DESCRIPTION
2011013	RI COMP SLIDE AL BLK

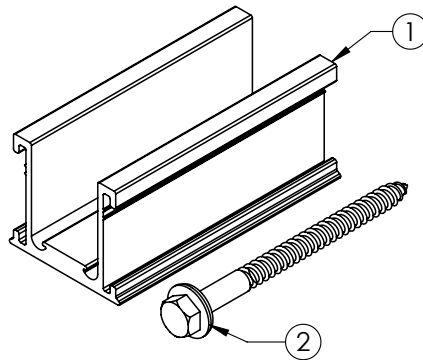

ITEM NO.	DESCRIPTION
1	ROCKIT V3 SLIDECOMP
2	LAG SCREW, 5/16-4", THREAD 3", EPDM BACKED WASHER

1) ROCKIT V3 SLIDECOMP

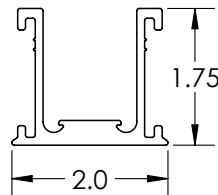
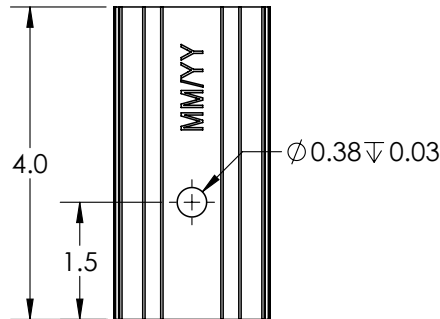

Material	Aluminum
Finish	Black

REV.- CS1

LINE DRAWINGS

GF-1

INSTALLATION GUIDE



SYSTEM COMPONENTS

1. **GF-1 Flashing:**

All flashing options come with a pre-installed integrated EPDM grommet and one bonded stainless steel EPDM washer. Flashing are available in three options:

1. 8 x 12" .032 gauge galvalume with mill or black (kynar painted) finish.
2. 8 x 10" .032 gauge galvalume with black (kynar painted) finish.
3. 8 x 12" .032 gauge aluminum with black (kynar painted) finish.

2. **Aluminum Compression Bracket:**

Compatible with a variety of EcoFasten compression brackets. EcoFasten compression brackets are made out 6000 series aluminum with options available for mill or black finishes depending on the bracket.

3. **Recommended Fasteners**

5/16"x4" lag bolts. 3" option also available.

4. **Recommended Sealant:**

If required by roof manufacturer, sealant shall be roof manufacturer approved.

DELIVERY / STORAGE / HANDLING

Inspect material upon delivery. Notify manufacturer within 24 hours of any missing or defective items. Keep material dry, covered and off the ground until installed.

GF-1

INSTALLATION GUIDE



EcoFasten[®]
For Installers. By Installers.

FLORIDA PRODUCT APPROVAL

Approved for any combination of 8"x12" GF-1 flashing with the ClickFit L-foot & Lag Screw.

PATENTS

Visit www.efpatents.com for patent information.

DESIGN REQUIREMENTS

1. Bracket spacing to be recommended by project engineer.
2. It is important to design new structures or assess existing structures to make sure they withstand retained loads.

EXAMINATION

1. Substrate: Inspect structure on which brackets are to be installed and verify that it will withstand any additional loading that may be incurred.
2. Notify General Contractor of any deficiencies before installing EcoFasten Solar brackets.
3. Verify that roofing material has been installed correctly prior to installing solar attachment bracket.

INSTALLATION

Comply with architectural drawings and project engineer's recommendation for location of system. Comply with Manufacturer's written installation instructions for installation and layout.